

INSTALLATION GUIDE

Shed roof tiles



Position the right shed verge tile at the end of the ridge. Fasten it to the batten which hold the base tile below using a nail in or mount on stormclip.



Hook the universal shed roof stormclip into the sidelock and mark the bending point on it where it touches the batten.

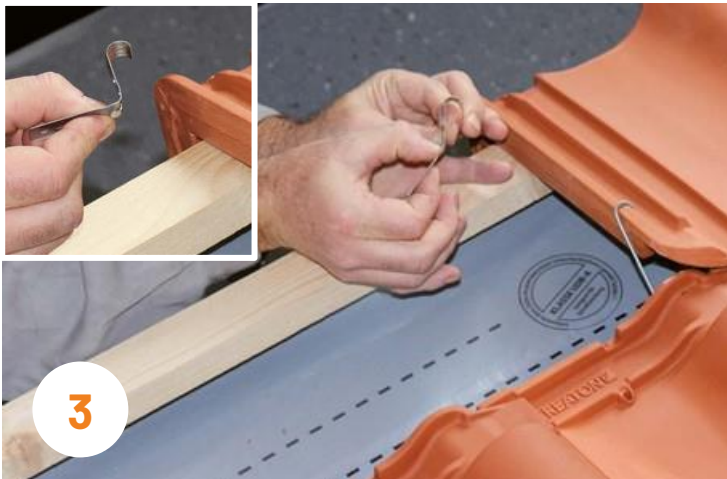

Bend the storm clip by hand or with pliers at the mark and position it correctly.



Use a stainless steel wood screw with a diameter of at least 4.5 mm to fasten the stormclip to the batten.

Screw it in to a depth of at least 24 mm.



Position all other shed roof tiles to the ridge and fasten them with stormclips and additional universal stormclips as described above.

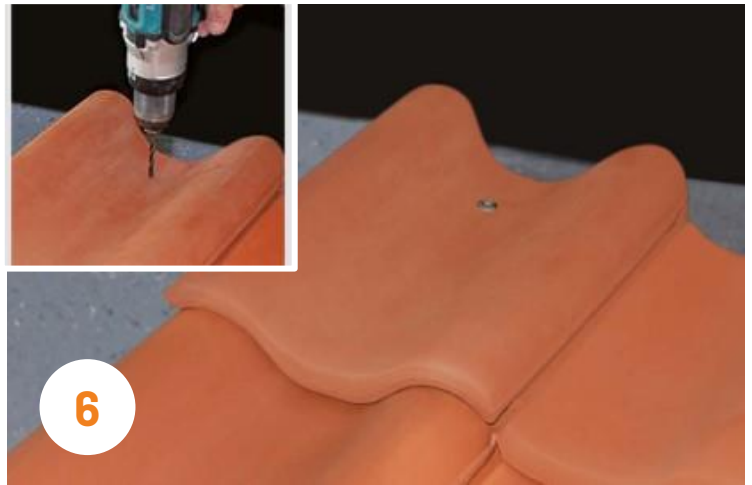

Drill a hole with 6 mm diameter in the left verge shed roof tile, and fasten it to the topmost batten through this hole using a stainless steel screw with a diameter of at least 4.5 mm.